

SC-F3030 User Self Repair Quick Guide

Things to take note before performing User Self Repair: -

- Perform **Maintenance** (Refer to User's Guide)
- **Adjustment film sheet** to be loaded on machine for calibration.
- Make sure there is "**Internet Connection**".
- ****Only Print Head** can be replaced in this mode******.
- For more details, please refer to "**How to Replace Print Head**" for further instructions.

WORKFLOW for USER SELF-REPAIR

How to activate User Self Repair function



In "OFF" mode, Place right thumb or an approximately 25 mm (0.98 in.) diameter coin on the area shown in the illustration of the printer screen below, so it is not exposed to light.

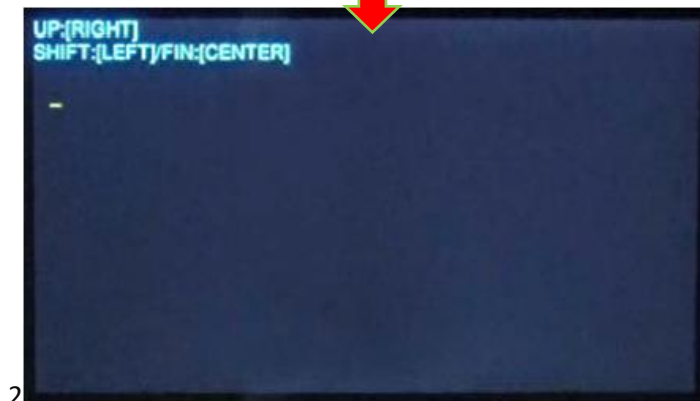

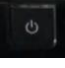
While maintaining the conditions from step 1, press and hold the power button  until the screen in the illustration appears. (about 20 sec). If the screen in the illustration does not appear, and the power just comes on as normal, turn off the power and redo the procedure from step 1.



Input the "**32998**" passcode.
 Press the right side of the screen to change the numbers from 0 to 9.
 Press the left side of the screen to confirm the selected number and advance to the next digit for input.



Press the center of the screen 2 times to confirm the passcode.

The printer starts in User Self Repair Mode.



Check the on-screen messages, and then press **OK**.



You have entered successfully if **User Self Repair Mode** appears in the upper left of the screen, as in the illustration.

If it does not appear, turn off the power and redo the procedure from step 1.



Scan this QR code to watch video on "How to activate User Self Repair mode".

SC-F3030 Print Head replacement

Things to take note before performing Print Head replacements: -

- Only **Print Head** can be replaced in this mode
- Replace Print Head only if **Print Head reached end of life** or **Print results are not right!**
- Use User Self Repair Diagnosis to determine Print Head replacement
- Nozzle compensation "**Turn On**".
- **Adjustment Film Sheet** - For Print Head Nozzle Check and Adjustments
- **M size platen** - Remove grip pad.
- Make sure printer connected to "Internet".

WORKFLOW for REPLACING PRINT HEAD

When a Print Head Needs to Be Replaced?

A Print Head needs to be replaced in the following situations. (The work is different for both/two situations. )

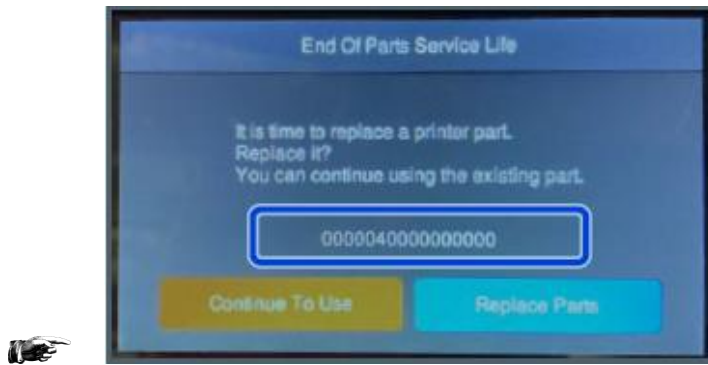

**If a number other than those above is displayed, contact your dealer or Epson Support and tell them the 16-digit code.

A Print Head has reached the end of its service life if any of the following 16-digit numbers appears in the enclosure shown on screen.

**0000020000000000/0000040000000000
/0000060000000000**

Take note of the number, then press **Replace Parts** to turn off the printer. Next, start the printer in User Self Repair Mode, and then replace the Print Head with the replacement one.



When print results are not correct:

If the print results are not improved after doing the following measures, start the printer in User Self Repair Mode and do a **Diagnosis**.

- Execute **Head Cleaning - Cleaning (Heavy)**

If the clogs are not cleared after doing this once, then execute **Cleaning (Heavy)** again one more time.

- Clean around the Print Heads and the edges of the metal
- Clean the Suction Cap
- Replace the Anti-Drying Caps

For the procedures to clean and replace the various parts, refer to **User's Guide - Maintenance**.

Only replace a Print Head with a replacement one if the **Diagnosis** determines that a Print Head needs to be replaced.

Understand how to hold Printhead

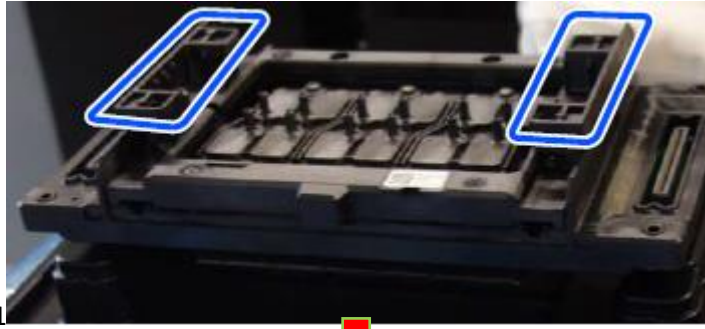

Correctly Holding the Print Head



Use both hands at the positions outlined in the illustration to hold the Print Head, such as to replace it or take it out of the protective case.

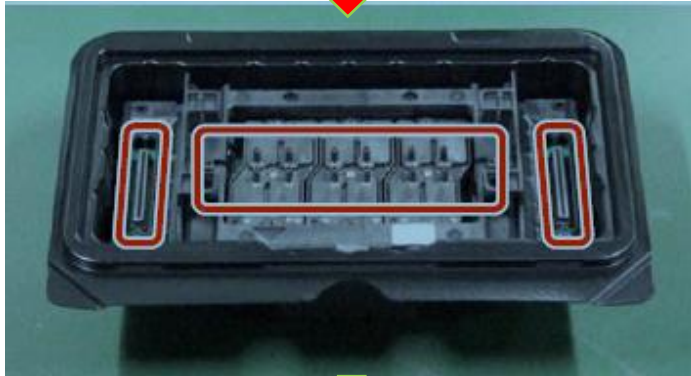

Do not touch the areas outlined in the following illustration when handling the replacement Print Head. Otherwise, a malfunction may occur.

Connectors (left/right) and ink supply ports

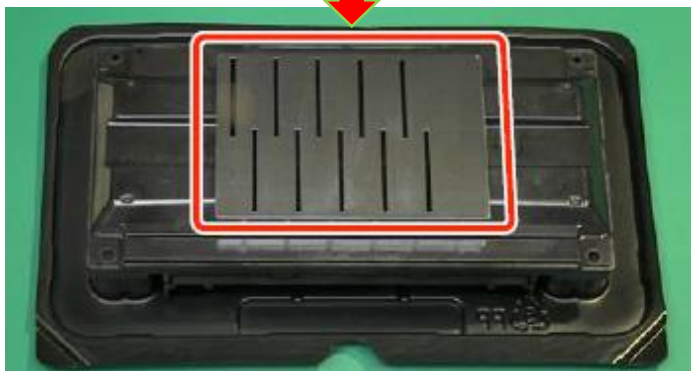

Nozzle surfaces (bottom side of Print Head)

Pack the used Print Head according to the following procedure, and then contact your dealer or Epson Support.



1. Apply commercially available adhesive tape to the contacts of the connectors on the used Print Head. Be sure to apply the tape so that any ink left in the nozzles cannot leak out during transport and get into the contacts of the connectors.
2. Put the Print Head into the protective case and close the lid.
3. Put the protective case in the plastic bag that came with the replacement Print Head, and then put it all in the outer carton and seal it with adhesive tape. Pack it securely so that the Print Head does not come out of the box during transport.

How to start replace Print Head function in User Self Repair mode

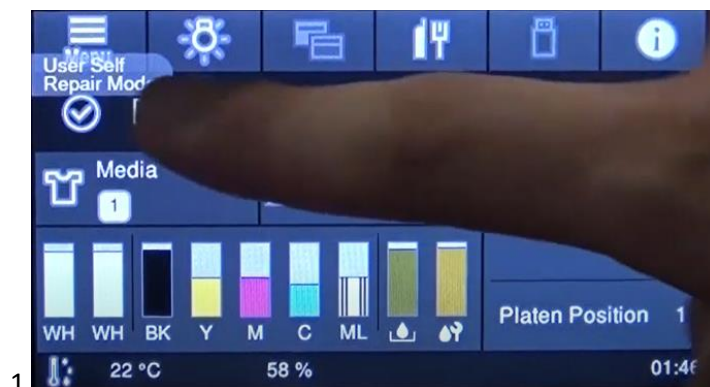

1

- Start the printer in User Self Repair Mode.
- ! Important:**
Touch a metal object before starting operations to disperse any static electricity from your body.



2

- Press in the order of (menu) - **Maintenance > Repair Menu > Replace Print Head.**

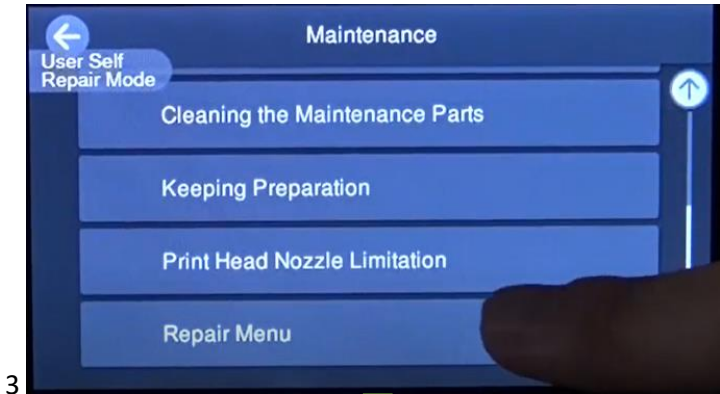

- Press Repair Menu





- Press Replace Print Head.

! Important:
If you select the wrong one, the end of service life error and the print result malfunction will not be eliminated and you will need to redo the work. Also, if the Print Head is installed incorrectly, it cannot be reused. Select this carefully.

Number	Item to select
0000020000000000	Color (front side)
0000040000000000	White (back side)
0000060000000000	Select both

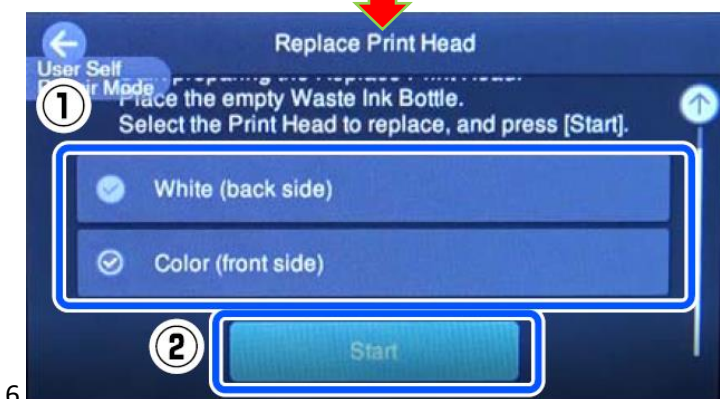
The table shows the relationship between the number that is displayed for the end of service life error and the item you should select.



The  icon indicates the Print Head that is selected to be replaced.
 (In the illustration, the **Color (front side)** is to be replaced.)
 Check the on-screen messages, and then press **Start**.



Please Scan for video on "how to replace Print Head".

How to use diagnosis

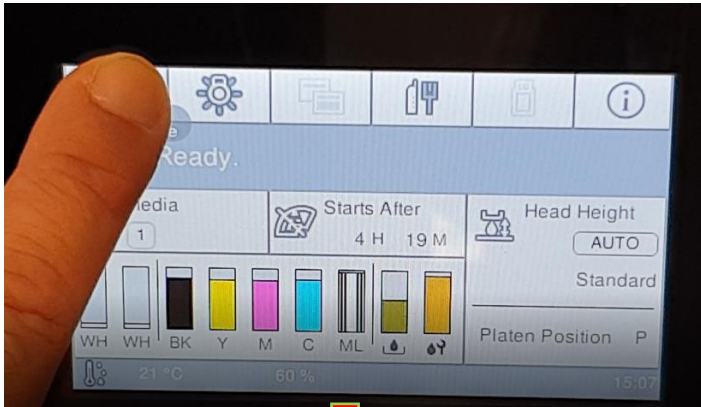

Start in User Self Repair mode,
Press **Menu** button.

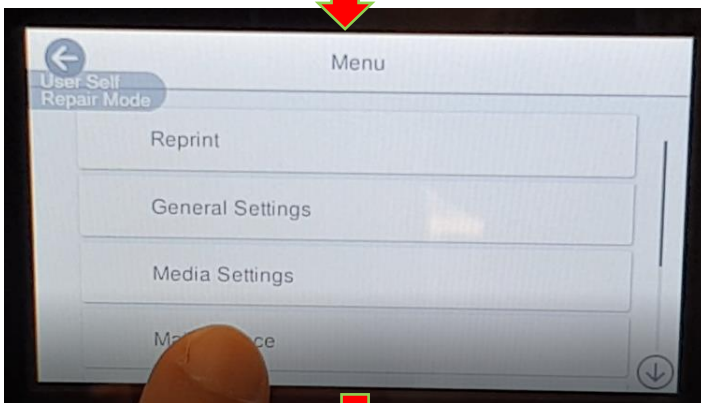

Select **Maintenance** button



Select **Repair Menu** button



Select **Diagnosis** button

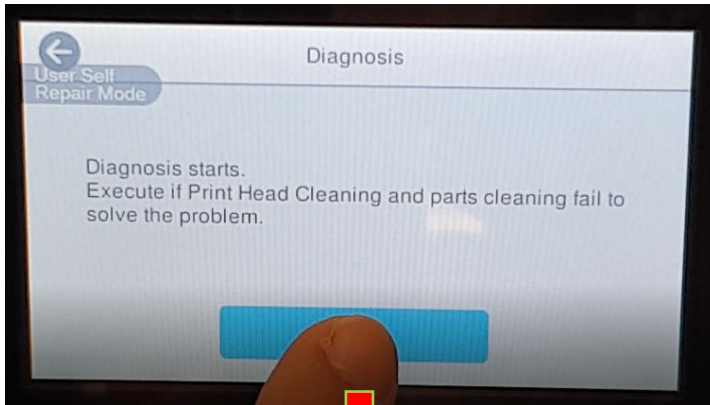

Select **Start** button

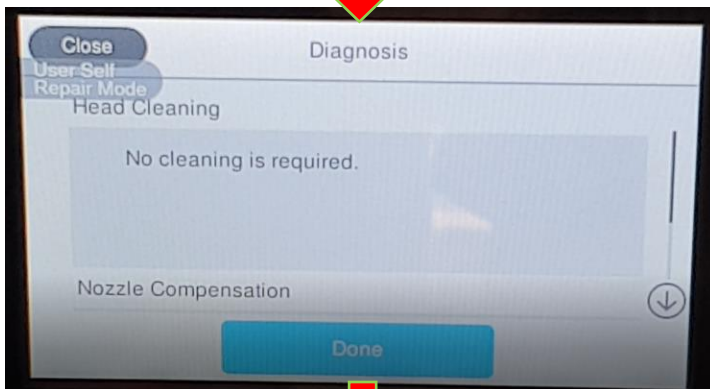

Follow the instruction on screen, if there is a need to do cleaning. Please follow instruction in How to Replace Print Head guide on "How to do Diagnosis (page 11)".

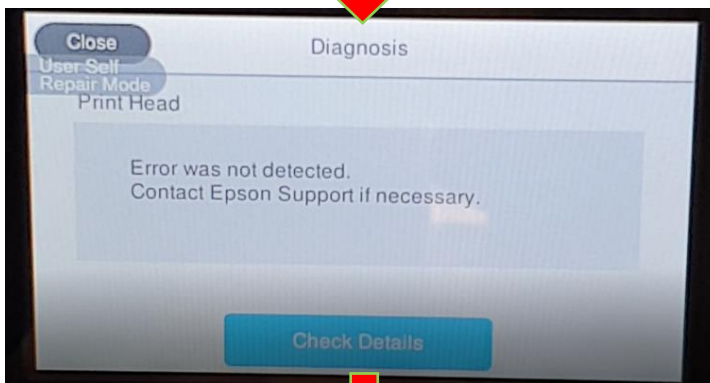

Screen will show if no error is detected.

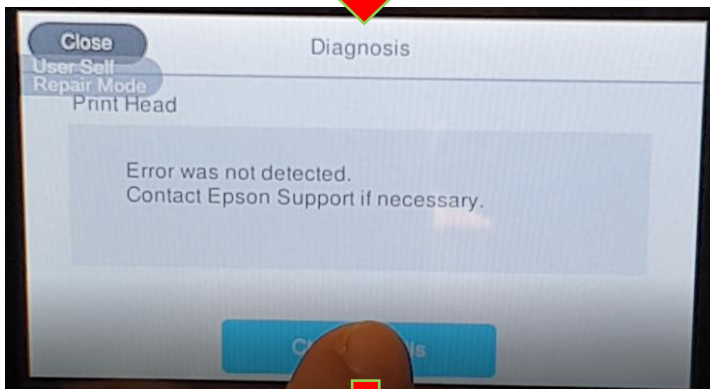

Press **Check Details**, for further information.

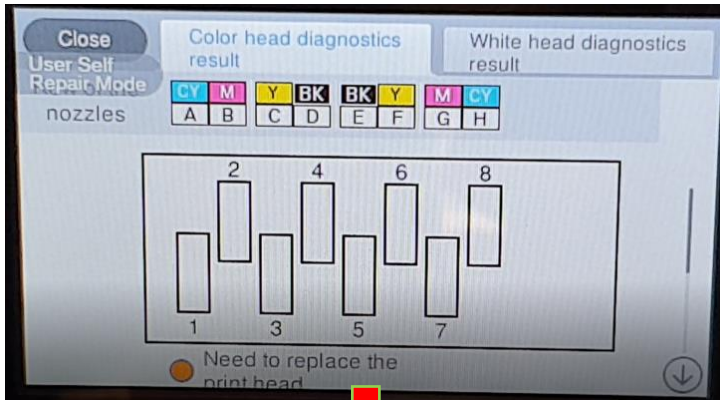

Screen will show which printhead needs or do not need replacement.

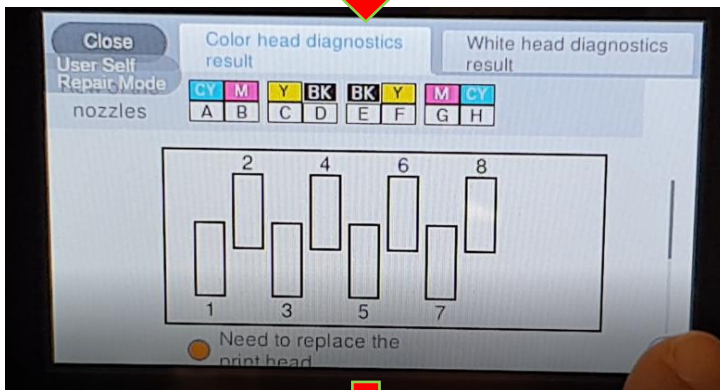

Press arrow down key to see amount of fail nozzle.

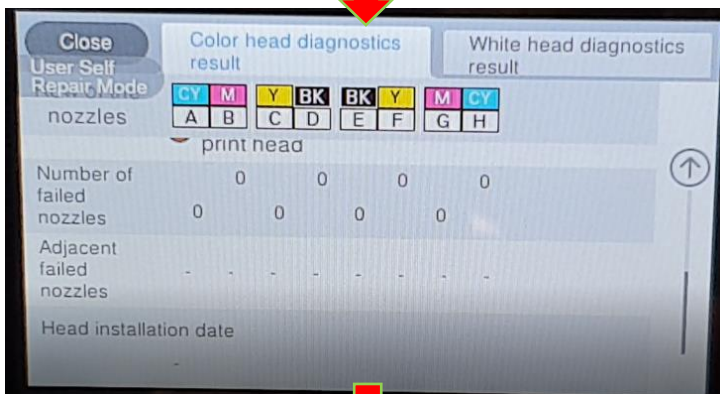

This Screen will show number of fail nozzle.

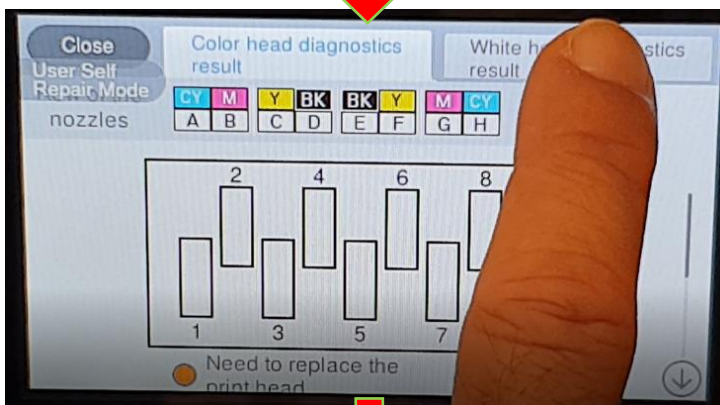

You can also check on "white head diagnostics results by pressing this button.

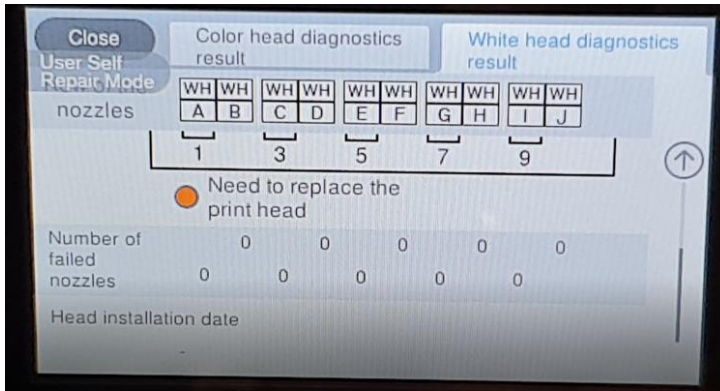

Number of fail nozzle will also be shown when you press arrow down button. Press **close** X2 on upper left-hand corner of screen to exit this mode.

Process After replacement

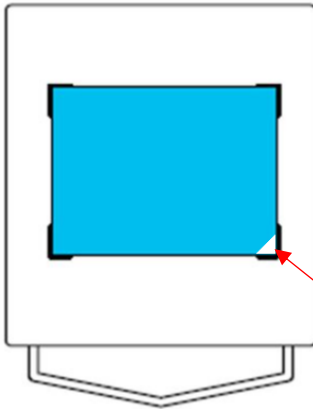

- M size platen without a grip pad
- Start the printer in User Self Repair Mode. The ink starts filling.
- Position film sheet on centre of platen as show in the illustration on the left.
- When the screen changes to Print Head Nozzle Check, press Start. The nozzle check pattern is printed.
- Check the nozzle check pattern. If there are no clogged nozzles, select . If there are clogged nozzles, select , and then do Head Cleaning until the clogged nozzles are cleared.
- When the screen changes to Print Head Alignment, all the head replacement work is complete.
- Take note on the direction to place the (cut corner) film sheet

Adjustment Work

Adjustment work comprises 3 types of adjustments that are done in **order**.

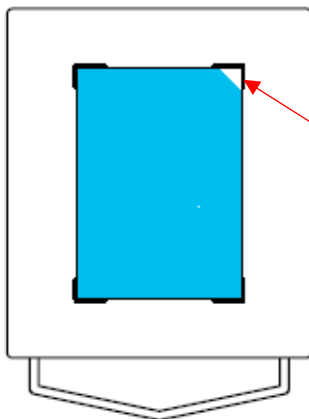

- M size platen **without** a grip pad
- Position film sheet on centre of platen as show in the illustration on the left for **Print head alignment, Head Interval X Uni-D Adjustment** and **Head Interval Y Adjustment**. **(Do adjustment in this order)**
- Take note on the direction to place the (cut corner) film sheet

Execute Print Head Alignment

1. Press Start, pressing the  button starts printing the adjustment pattern. When printing the pattern is complete, the adjustment value entry screen is displayed. Continue to the next procedure.
2. Check the printed adjustment pattern.

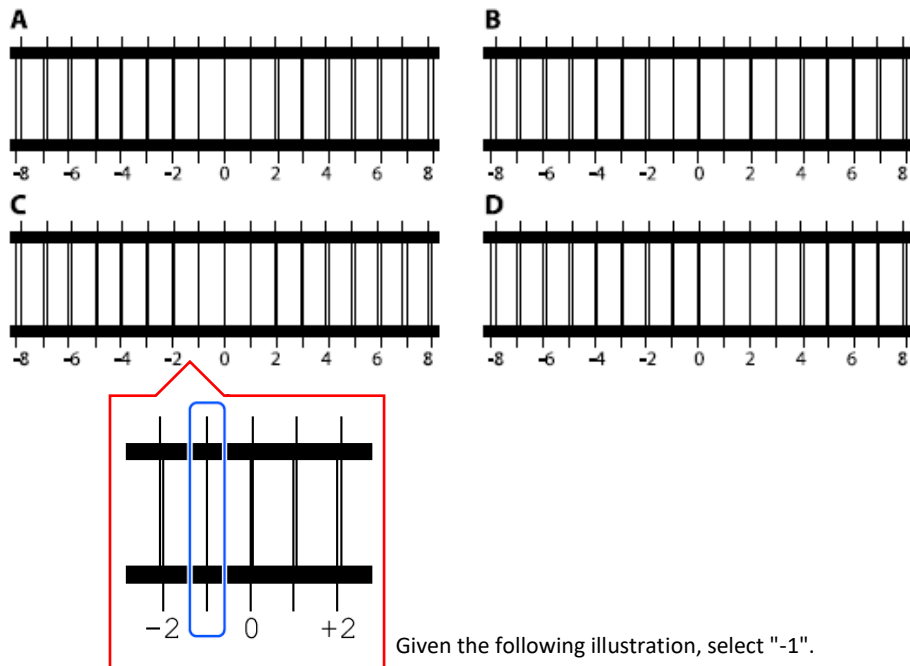

Check the 4 patterns A to D, and select from -8 to +8, where the line appears thinnest (lines overlap) in the pattern.

3. Input the adjustment values. Input the adjustment values in order A to D that you selected in step 6 for all of the blocks #1 to #4. Inputting all of the adjustment values and pressing OK opens a screen for confirming the adjustment values. Check the adjustment results and press OK to reflect the adjustment results to the printer.



Please Scan for video on "How to execute Print Head Alignment".

Executing Head Interval X Uni-D Adjustment

1. Press Start, pressing the  button starts printing the adjustment pattern. When printing the pattern is complete, the adjustment value entry screen is displayed. Continue to the next procedure.
2. Check the printed adjustment pattern.

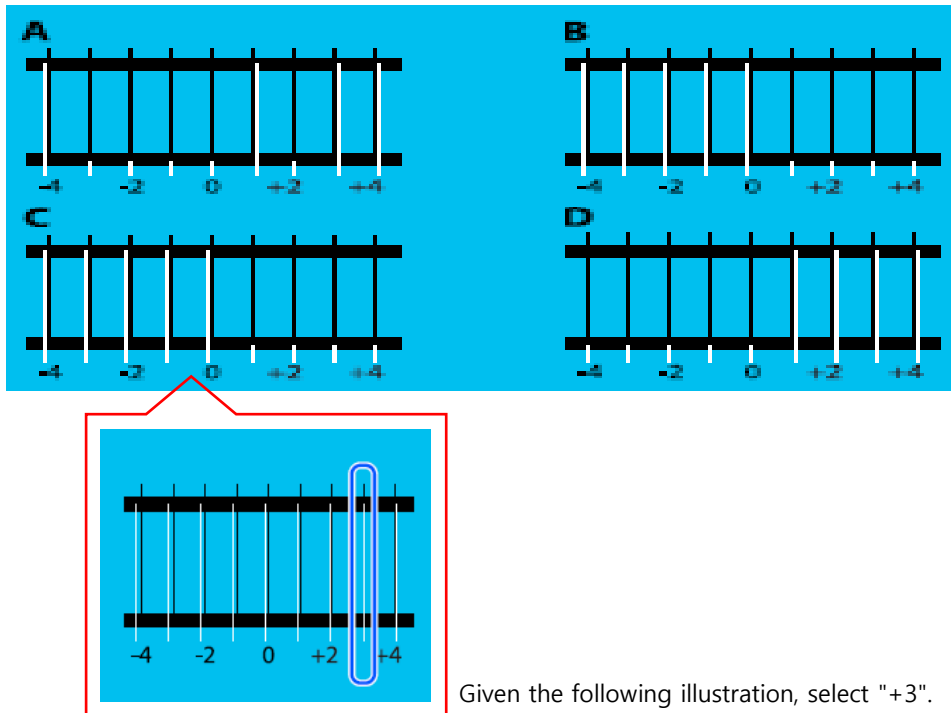

Check the pattern, and select from -4 to +4, where the white and black lines overlap most closely in the pattern.

3. Input the adjustment values. Input the adjustment values in order A to D that you selected in step 2. Inputting all of the adjustment values and pressing OK opens a screen for confirming the adjustment values. Check the adjustment results and press OK to reflect the adjustment results to the printer.



Please Scan for video on "How to execute Head Interval X Uni D Adjustment".

Executing Head Interval Y Adjustment

1. Press Start, pressing the  button starts printing the adjustment pattern. When printing the pattern is complete, the adjustment value entry screen is displayed. Continue to the next procedure.
2. Check the printed adjustment pattern.

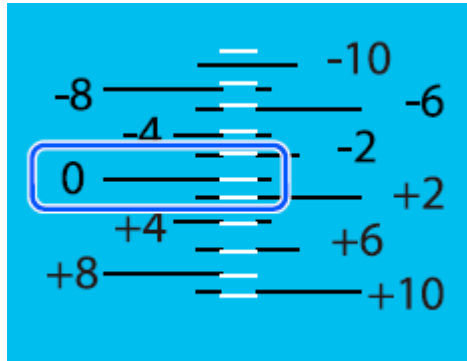

Given this illustration, select "0".

Check the pattern, and select from -10 to +10, where the white and black lines overlap most closely in the pattern.

3. Input the adjustment values. Inputting the adjustment values selected in step 5 and then pressing **OK** opens a screen for confirming the adjustment values. Check the adjustment results and press **OK** to reflect the adjustment results to the printer.
4. When the screen display returns to the home screen, all the adjustment work is complete.



Please Scan for video on "How to execute Head Interval Y Adjustment".

END